

## SWEDX SDS58K8-01-DC

### Mounting Instructions



**NOTICE:** The monitor should be mounted by at least 2 persons.

Bachmann GmbH  
Ernstaldenstraße 33  
70565 Stuttgart  
Germany  
Telefon: +49 711 86602-0  
Telefax: +49 711 86602-34  
E-Mail: [info@bachmann.com](mailto:info@bachmann.com)  
Internet: [www.bachmann.com](http://www.bachmann.com)

# Mounting Instructions

**Step 1:** Pull the locking pin and insert the battery module (#700.0000).



**Step 2:** Switch on the battery and adjust the monitor box to reachable height.



**Step 3: Loosen the screws on the back of the monitor box.**

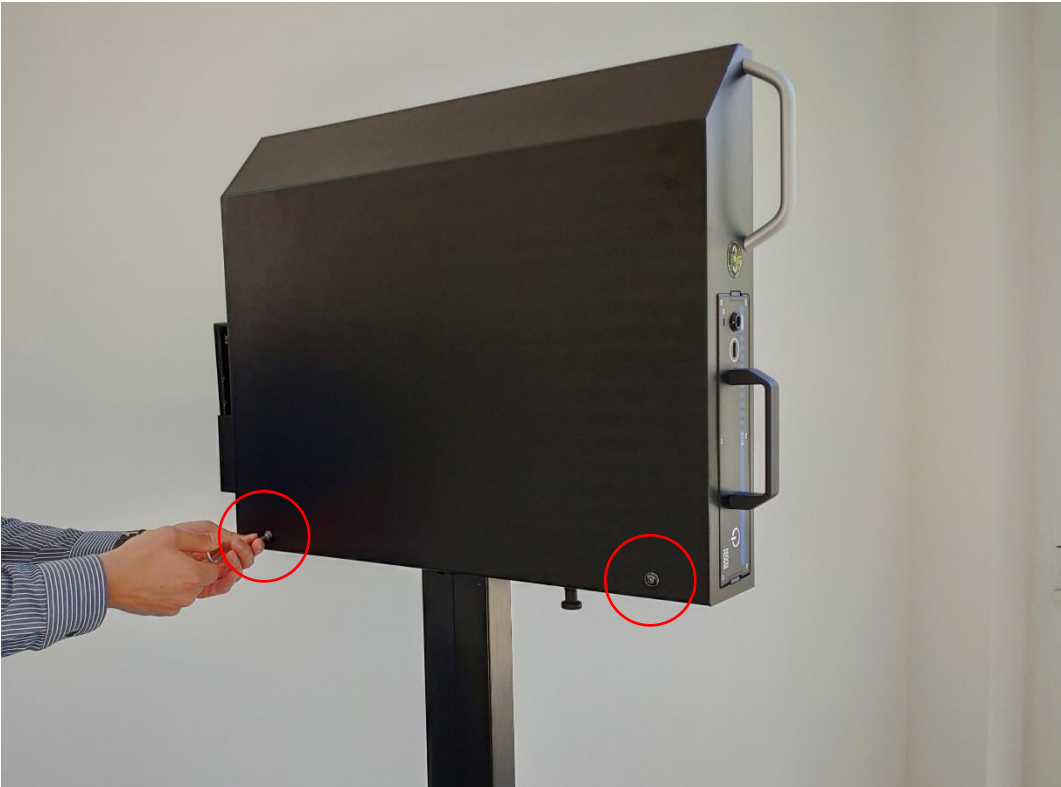

**Step 4: Remove the monitor box cover and set it aside.**



**Step 5: Pull the locking pin and remove the battery.**



**Step 6: Hang in the monitor with the pre-assembled adapter rods.**

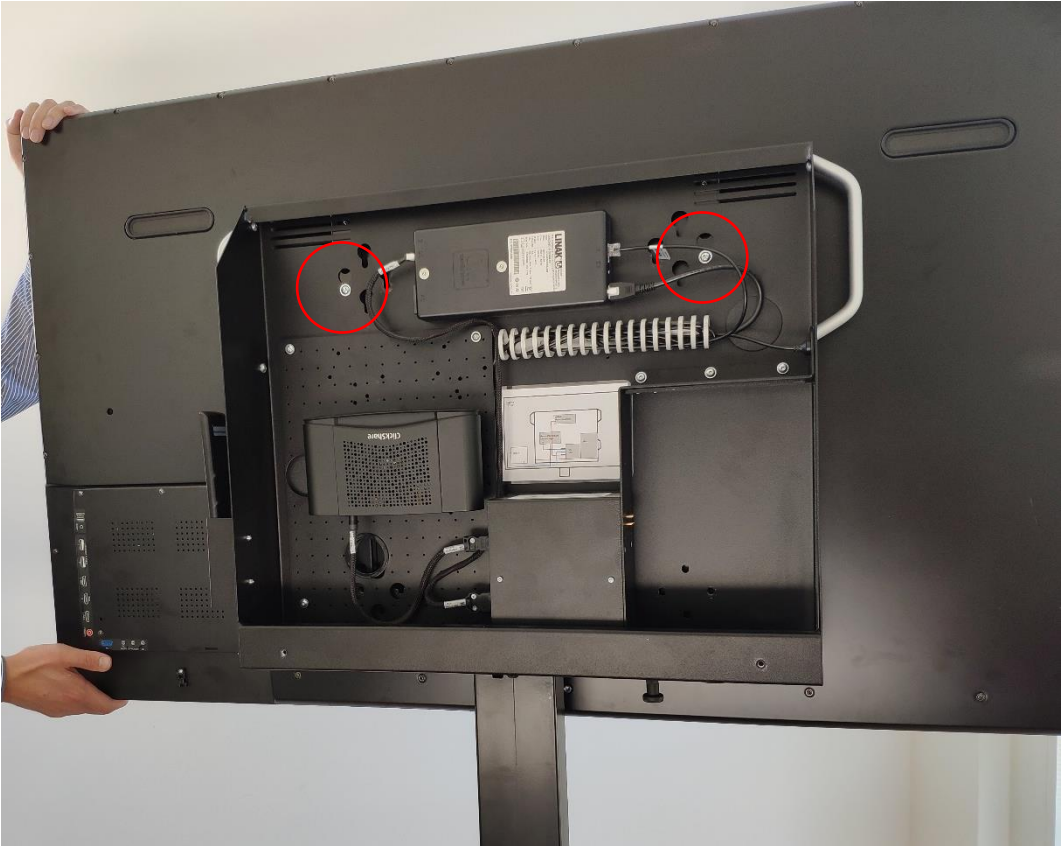



**Step 7: Tighten both screws in the upper region of the monitor box.**



**Step 8: Tighten both screws in the lower region of the monitor box.**



**Step 9: Connect the DC supply cable (#149.0000) with the Docking Station.**



**Step 10: Pass the DC supply cable through the cable bushing.**

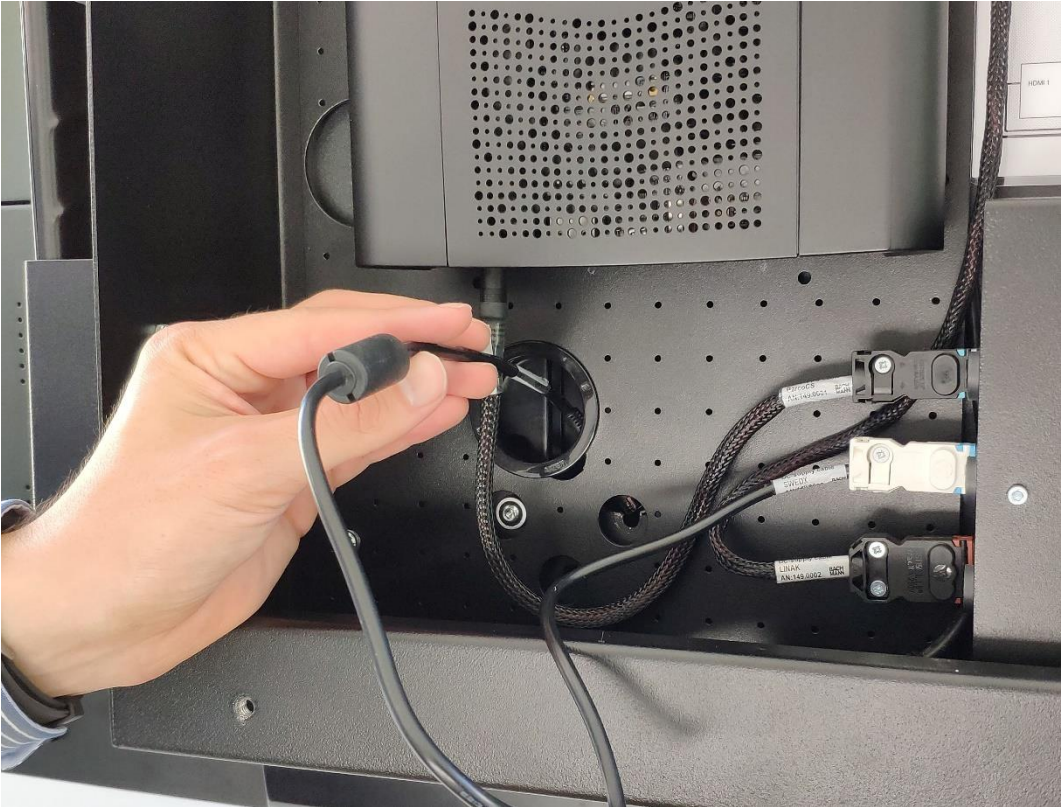



**Step 11: Plug the DC supply cable into the monitor.**

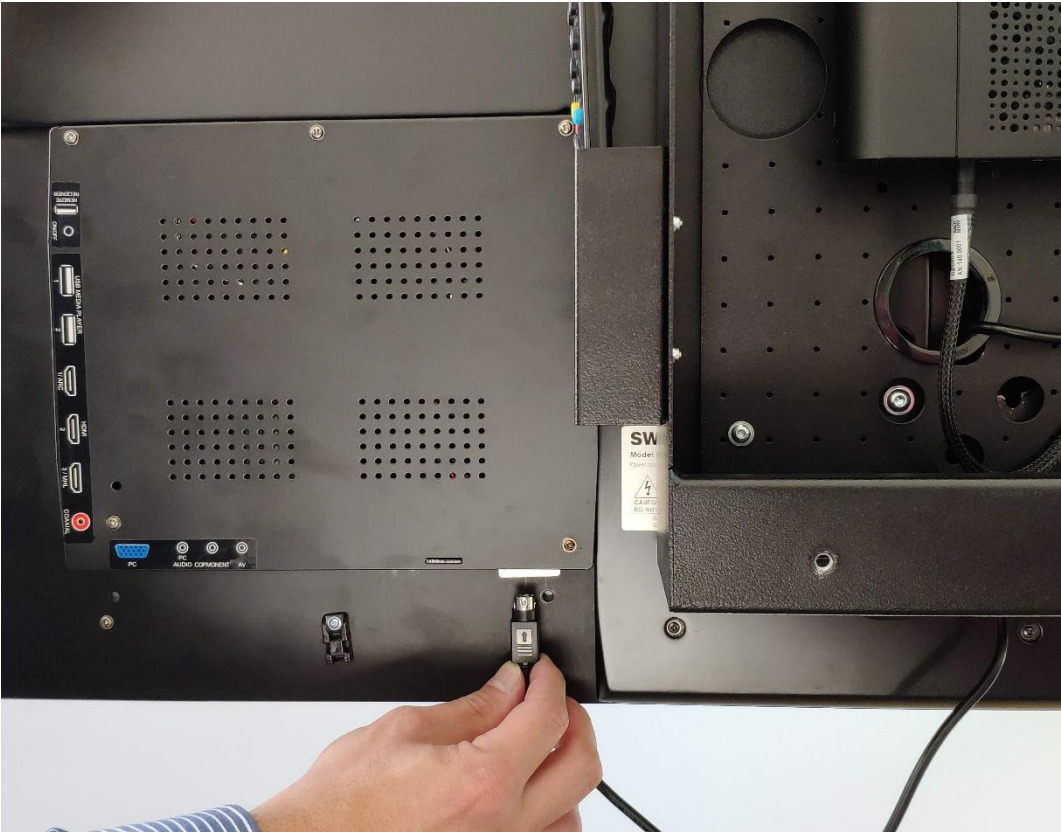

**Step 12: Connect the HDMI cable to the media equipment and monitor.**

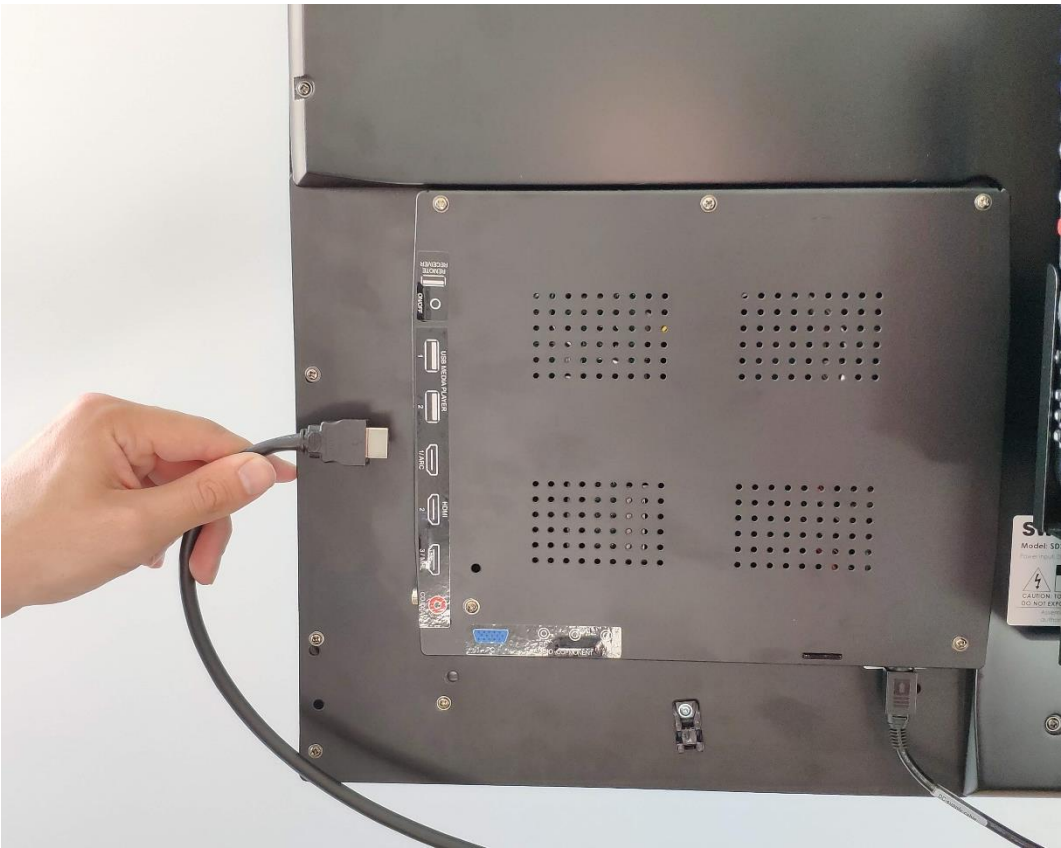

**Step 13:** Fix the cable with cable ties.

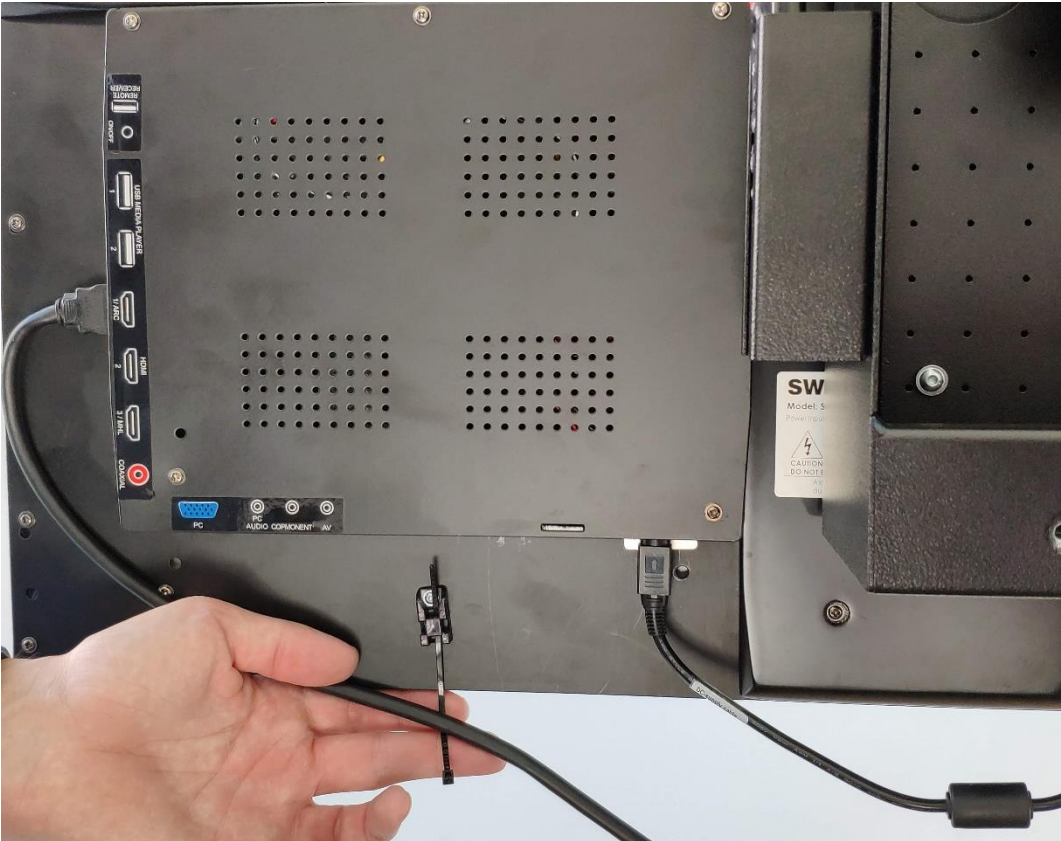

**Step 14:** Sort the cables and cut off cable tie.





**Step 15:** Close the monitor box cover.



**Step 16:** Tighten the screws on the backside of the monitor box.

